

Specification and information for Endurance composite doors

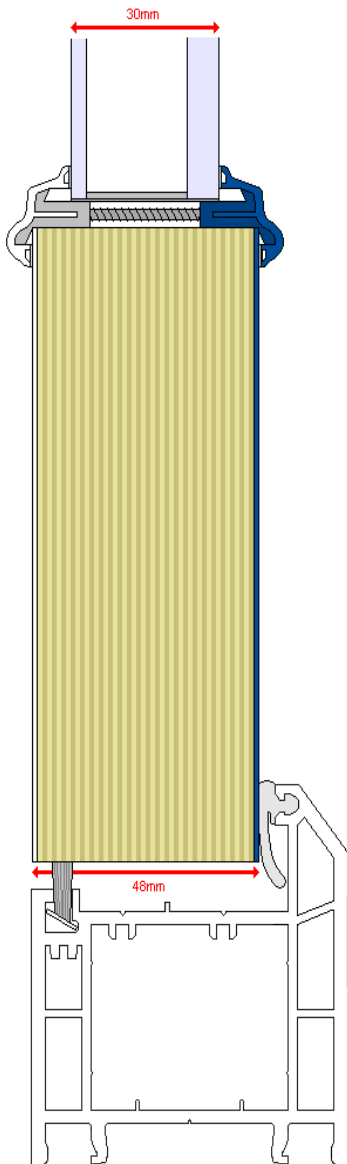

DOOR LEAF COMPOSITION

The inner and outer skins are manufactured from vacuum formed 1.5mm thick PVC sheet called Paldoor Cool. The Paldoor Cool skins are UV Stabilised and are self-extinguishing once the flame has been removed. (Class 1 Surface Spread of Flame BS476 Part 7). When vacuum formed, the Paldoor Cool skins have a woodgrain effect finish.

The leaf core consists of a solid 45mm core of "Kerto q (lv)", tested to BS476: part 22 1987, accredited with BBA 00/3717 and compliant with ISO9001 & ISO2000 requirements.

Kerto consists of 15 3.2mm thick veneers, three of which are laid cross grain. All veneers are scarf jointed except the middle one which is butt jointed.

The skins are bonded to the Kerto using a moisture-cured adhesive.

The edge of the door leaf is fully sealed with a 1.5mm ABS edge band. The adhesive used is a moisture resistant hot melt.

GLAZING

All sealed units are 30mm thick and are manufactured with toughened safety glass. The sealed unit is glazed into the door using a glazing cassette system. The cassette is pre-finished to match the door.

Outer Frame

The Outer frame is manufactured from 70mm deep (Rehau S706) profile and is fully welded and reinforced with a multi-channel PVC reinforcing. Rehau is BBA approved and manufactured to BS7413.

The external seal on the outer frame is Q-Lon, which is available in white or black. The internal seal is a grey brush pile.

DOOR HARDWARE

The locking system is a Winkhaus Trulock multi point lock. This consists of a top and bottom hook bolt, centre latch and deadbolt. There are 3 laterally adjustable keeps.

The door leaf is fixed to the frame with 3 Basta Parsons Flag hinges. They have lateral, vertical and compression, adjustment. A high security pin and locking screw are incorporated into the hinge. The door handles conform to BS7412 clause 4; die cast alloy to BSEN 12844, steel parts to BS970 part 1.. The door handles are salt spray tested to withstand 240 hours.

The door leaf is fitted with a weather bar deflector manufactured by Exitex.

LOW THRESHOLD

The door frame can be supplied with a 95 or 150mm external cill.

A part M compliant aluminium mobility threshold manufactured by Exitex can be fitted if required.